

**PERMIT**

**CITY OF NAPOLEON, OHIO — DEPT. OF BUILDING & ZONING**  
**255 W. Riverview Avenue, Napoleon, Ohio 43545 (419) 592-4010**

Permit No. 811 Date April 30, 1984  
 Job Location 521 E. Washington Valuation \$ 580.00  
 Owner James Lane Address 521 E. Washington  
 Contractor " " Telephone No. \_\_\_\_\_  
 Address 521 E. Washington, Napoleon, Ohio 43545  
 Electric Contractor \_\_\_\_\_  
 Plumbing Contractor \_\_\_\_\_  
 Mechanical Contractor \_\_\_\_\_

**This permit is issued for work described in the plans, specifications, and/or application submitted, as approved by the Building Commissioner of the City of Napoleon, Ohio. Work shall conform to all pertinent construction and land use Codes and Ordinances.**

Work Information:

Residential  Commercial \_\_\_\_\_ Industrial \_\_\_\_\_  
No. dwelling units  
 New Construction \_\_\_\_\_ Addition \_\_\_\_\_ Remodel \_\_\_\_\_  
 Brief Description of Work REBUILD PORCH FLOOR & FOUNDATION WITH FOOTER

ISSUED BY Richard G. Heyman DEPT. OF BUILDING & ZONING  
Building Official

**It is the owners or contractors responsibility to call the Building Department for the following (x) inspections:**

- Footing excavation prior to placing concrete.
- \_\_\_\_\_ Footing drains and foundation prior to backfill.
- \_\_\_\_\_ Prepared sub-grade prior to placing concrete floor slab.
- \_\_\_\_\_ Sanitary sewer
- \_\_\_\_\_ Rough-in electrical, plumbing and service framing prior to installing wall board.
- \_\_\_\_\_ Final electrical, plumbing and heating.
- Final building inspection, prior to occupancy.

**PERMIT & FEES**

Building Permit	\$ <u>6.00</u>
Electrical Permit	\$ _____
Plumbing Permit	\$ _____
Mechanical Permit	\$ _____
Demolition Permit	\$ _____
Zoning Permit	\$ _____
Sign Permit	\$ _____
Water Tap	\$ _____
Sewer Tap	\$ _____
Temp. Elec.	\$ _____
Other	\$ _____

TOTAL FEES \$ 6.00  
 LESS FEES PAID \$ \_\_\_\_\_  
 BALANCE DUE \$ -0-

**PAID**  
**APR 30 1984**  
**CITY OF NAPOLEON**

**Permit is not valid until all fees are paid in full, and shall be void if work is not started within six months of date above.**



CITY OF NAPOLEON  
 BUILDING INSPECTION DEPARTMENT  
 APPLICATION FOR BUILDING PERMIT  
 (Please print or type)

The undersigned hereby makes application for construction, installation, or alteration work as herein specified, agreeing to do all such work in strict accordance with the City of Napoleon's adopted Building Codes.

Location of project 521 E WASHINGTON Cost of project \$ 580  
 Owner's Name JAMES LANE Address \_\_\_\_\_  
 Contractor SAME Telephone No. \_\_\_\_\_  
 Address \_\_\_\_\_

Lot Information: (Not required for siding job)

Lot No. \_\_\_\_\_ Subdivision \_\_\_\_\_  
 Zoning District \_\_\_\_\_ Lot Size \_\_\_\_\_ ft. X \_\_\_\_\_ ft. Area \_\_\_\_\_ sq. ft.  
 Setbacks: Front \_\_\_\_\_ Right Side \_\_\_\_\_ Left Side \_\_\_\_\_ Rear \_\_\_\_\_

Work Information:

Residential \_\_\_\_\_ Commercial \_\_\_\_\_ Industrial \_\_\_\_\_  
 New Construction \_\_\_\_\_ Addition \_\_\_\_\_ Remodel \_\_\_\_\_  
 Accessory Building \_\_\_\_\_ Siding \_\_\_\_\_

Brief Description of Work: ----- REBUILD PORCH FLOOR (WOOD) & FOUNDATION with joists  
 (Specific Type)

Size: Length \_\_\_\_\_ Width \_\_\_\_\_ No. of Stories \_\_\_\_\_  
 Area: 1st Floor \_\_\_\_\_ sq. ft. Basement \_\_\_\_\_ sq. ft.  
 2nd Floor \_\_\_\_\_ sq. ft. Accessory Bldg. \_\_\_\_\_ sq. ft.  
 3rd Floor \_\_\_\_\_ sq. ft. Other \_\_\_\_\_ sq. ft.

Additional Information: \_\_\_\_\_

APPLICATION FOR PERMIT SHALL BE ACCOMPANIED BY TWO COMPLETE SETS OF PLANS INCLUDING: ELEVATIONS, FLOOR PLANS, CROSS SECTIONS AND PLOT PLAN. IF ADDITION OR REMODELING, SHOW ALL EXISTING STRUCTURES AND THEIR SIZE AND LOCATION. ALL PLANS SHALL BE DRAWN TO SCALE.

Date 4/30/84 Applicant's Signature James Lane

PERMIT NO. 811  
 PERMIT FEE \$ 6.00

Floors

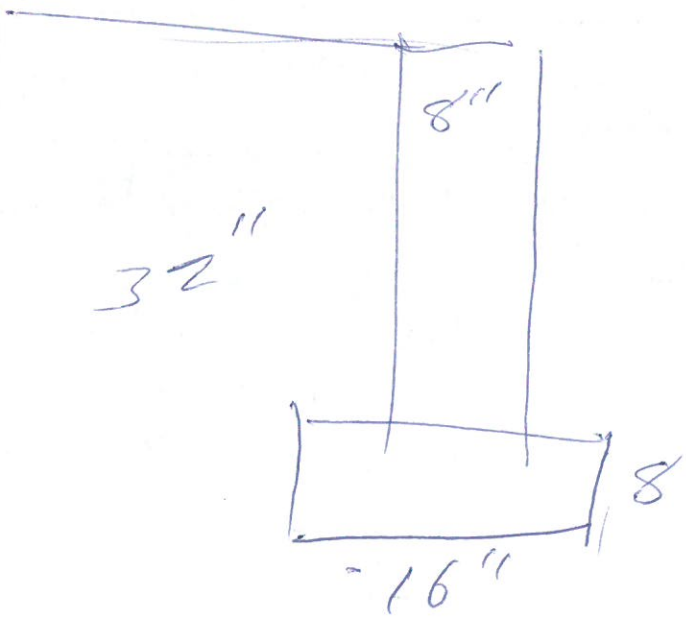
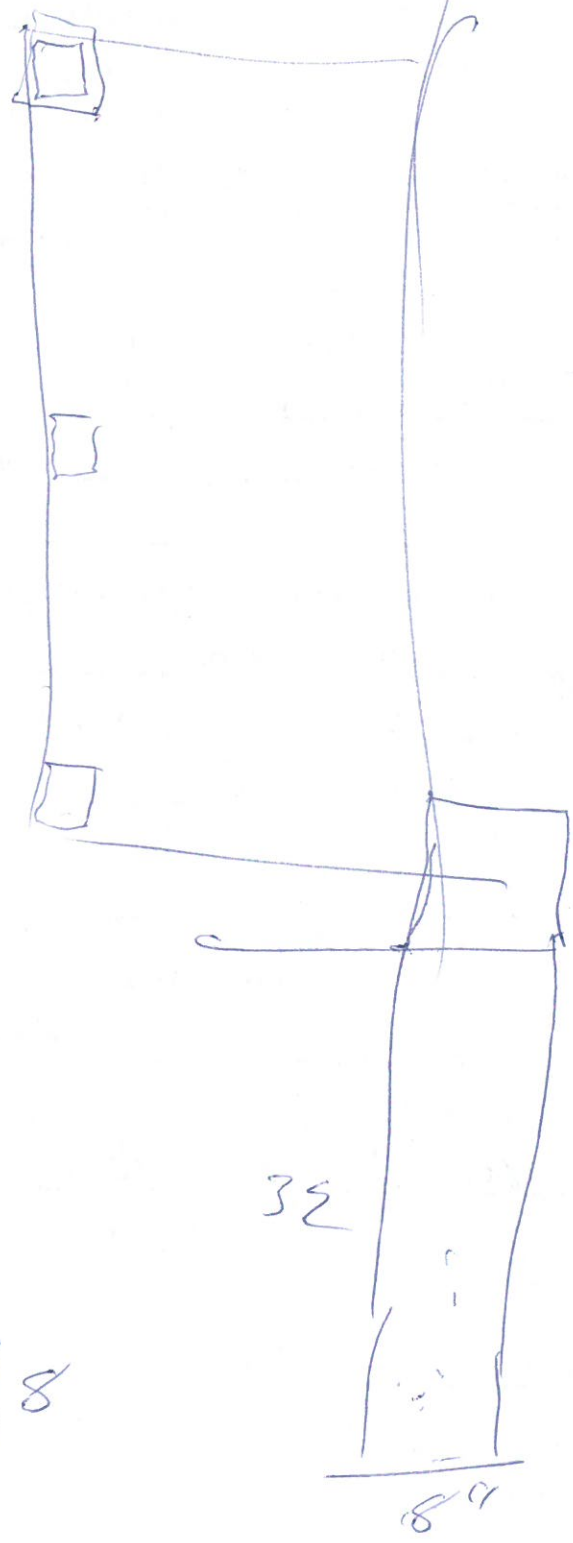

**PERMIT**

**CITY OF NAPOLEON, OHIO — DEPT. OF BUILDING & ZONING**

**255 W. Riverview Avenue, Napoleon, Ohio 43545 (419) 592-4010**

Permit No. 011 Date April 30, 1984  
 Job Location 521 E. Washington Valuation \$ 580.00  
Address  
 Owner James Lane Address 521 E. Washington  
Name  
 Contractor \_\_\_\_\_ Telephone No. \_\_\_\_\_  
 Address 521 E. Washington, Napoleon, Ohio 43545  
 Electric Contractor \_\_\_\_\_  
 Plumbing Contractor \_\_\_\_\_  
 Mechanical Contractor \_\_\_\_\_

**This permit is issued for work described in the plans, specifications, and/or application submitted, as approved by the Building Commissioner of the City of Napoleon, Ohio. Work shall conform to all pertinent construction and land use Codes and Ordinances.**

**Work Information:**

Residential  No. dwelling units Commercial \_\_\_\_\_ Industrial \_\_\_\_\_  
 New Construction \_\_\_\_\_ Addition \_\_\_\_\_ Remodel \_\_\_\_\_  
 Brief Description of Work PERMIT FOR 1st FLOOR + FINISH WORK FOR 1st FLOOR

ISSUED BY Richard G. ... Building Official DEPT. OF BUILDING & ZONING

**It is the owners or contractors responsibility to call the Building Department for the following (x) inspections:**

- Footing excavation prior to placing concrete.
- Footing drains and foundation prior to backfill.
- Prepared sub-grade prior to placing concrete floor slab.
- Sanitary sewer
- Rough-in electrical, plumbing and service framing prior to installing wall board.
- Final electrical, plumbing and heating.
- Final building inspection, prior to occupancy.

**PERMIT & FEES**

Building Permit	\$ <u>5.00</u>
Electrical Permit	\$ _____
Plumbing Permit	\$ _____
Mechanical Permit	\$ _____
Demolition Permit	\$ _____
Zoning Permit	\$ _____
Sign Permit	\$ _____
Water Tap	\$ _____
Sewer Tap	\$ _____
Temp. Elec.	\$ _____
Other _____	\$ _____

TOTAL FEES \$ 6.00  
 LESS FEES PAID \$ \_\_\_\_\_  
 BALANCE DUE \$ \_\_\_\_\_

**PAID**  
**APR 30 1984**  
 CITY OF NAPOLEON

**Permit is not valid until all fees are paid in full, and shall be void if work is not started within six months of date above.**

# INSPECTION RECORD

Made owner remove  
 Porch floor and put in footer  
 Poured concrete 8x32 and  
 laid ~~stone~~ new row of block.

UNDERGROUND			ROUGH-IN			FINAL		
Type	Date	By	Type	Date	By	Type	Date	By
<b>PLUMBING</b>								
Sewer Connection			Drainage, W. & Vent			Drainage, W. & Vent		
Building Sewer			Water Piping			Water Heater		
Water Piping			Condensate Lines			Backflow Prevention		
			Indirect Waste					
<b>ELECTRICAL</b>								
Floor Ducts Raceways			Rough Wiring			FINAL APPROVAL		
Conduits & Cable			Conduits/Cable			Electric Mtr. Clearance		
Grounding & Bonding			Service Panel			Signs		
			Switchboard					
			Subpanels					
			<input type="checkbox"/> Range <input type="checkbox"/> Dryer			FINAL APPROVAL		
<b>MECHANICAL</b>								
Refrigerant Piping			Refrigerant Piping			Duct Insulation		
Ducts/Plenums			Ducts/Plenums			Chimney(s)		
			Ventilation			Furnace(s)		
			<input type="checkbox"/> Supply			FINAL APPROVAL		
			<input type="checkbox"/> Exhst.					
<b>BUILDING</b>								
Location, Set-backs, Esmt(s)			Wall Construction			Fireplace Chimney		
Excavation			Crawl Space			Attic		
Footings & Reinforcing			<input type="checkbox"/> Vent <input type="checkbox"/> Access			<input type="checkbox"/> Vent <input type="checkbox"/> Access		
Sub-soil Drain			Floor System(s)			Special Insp Reports Rec'd		
Foundation Walls			Roof System			Smoke Detector		
Floor Slab			Fire Wall(s)			Demolition (sewer cap)		
			Roof Cover			Building or Structure		
			Roof Drain					
FINAL APPROVAL BLDG. DEPT			FINAL APPROVAL			Certificate of Occupancy Issued		#

*[Handwritten signature]*